



*Fabulous, functional, forever.*

# INSTALLATION GUIDE



A PRODUCT BY **EVA-LAST**  
INSPIRED BY NATURE, DESIGNED FOR LIFE

[www.tierflooring.com](http://www.tierflooring.com)

Thank you for selecting TIER™ indoor flooring. In these guidelines we aim to assist you in successfully completing an installation that will last as long as the TIER™ product themselves.

This guide will assist you in laying your TIER™ flooring boards in a staggered pattern.

Building codes and standards may differ between jurisdictions or counties,. Before installing TIER™ flooring, ensure that your designs are rational and comply with the local regulations and building codes, or consult a suitably qualified expert. Ensure that your choice of TIER™ is suitable for the application.

## PLANNING

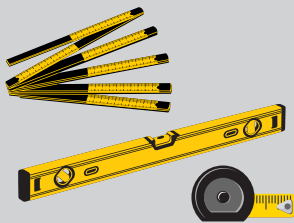

**PRECISION TOOLS**  
Spirit level, tape measure and ruler.

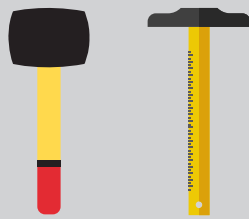

**HAND TOOLS**  
Rubber mallet and T-square.

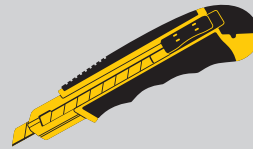

**CUTTING TOOLS**  
Utility knife or laminate cutter.



**SAFETY EQUIPMENT**  
According to applicable legislation.

- Plan your board laying direction for your project. It is common practice to install TIER™ flooring in the direction that natural light enters the room, this is typically perpendicular to a window.
- Areas of more than **400 m²** will require at least one expansion joint. Areas with continuous length of more than **30 meters** should have an expansion gaps. Smaller areas do not require expansion joints, even between rooms.
- Check door and door frame clearances before installation.
- TIER™ flooring must be held down around the edges with skirting. Plan to pass the TIER™ flooring beneath door frames where possible. The skirting serves four purposes: providing a cavity for expansion and contraction, holding the flooring down, preventing the ingress of dirt and hiding the imperfections of cut lines.
- Measure the room carefully to determine if the room is square; if not, the outer (particularly the last) floorboards will need to be cut to match the edges of the room.
- Decide which side of the room will have the last line of floorboards, it may appear more attractive to have this line at the outer edge of the room, away from adjacent rooms.
- When installing in connecting rooms it is best to start in a passage or in the center of the connecting rooms and work towards the outside of the rooms.
- Estimate the width of the last floorboard, if this is less than **50 mm**, start the first line of floorboards by cutting them in half down the length so that the last line of floorboards will be wider than **50 mm**.

One should stagger the transverse joints by cutting the first floorboard in each line shorter, for example, at consecutive lengths of **300 mm, 600 mm, 900 mm** and then a full floorboard. Alternatively, the off-cut from the final floorboard of the previous line can be used as the starting piece of the next line. It is, however, recommended that transverse joints in adjacent lines should be spaced at least **300 mm** apart.

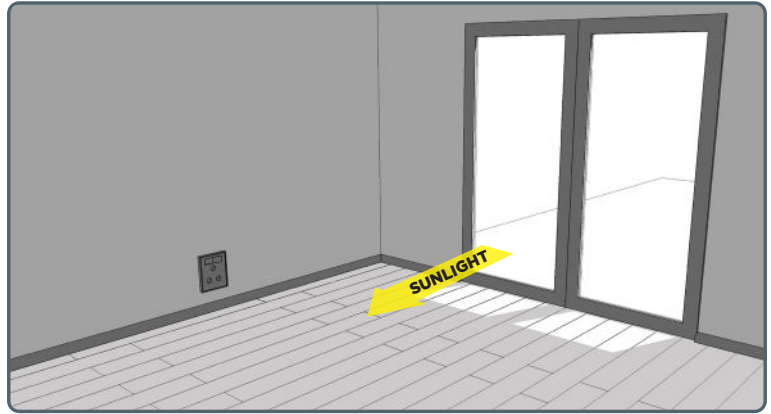

Plan your board laying direction for your project. It is common practice to install TIER™ flooring in the direction that natural light enters the room, this is typically perpendicular to a window.

## INSTALLATION

- Installation should be conducted in accordance with applicable local regulations.
- Wear suitable safety or protective equipment in compliance with local legislation.
- The surface on which TIER™ is installed should be prepared to be flat and dry.
- TIER™ flooring will follow the shape of the surface on which it is installed.
- Remove carpet staples, nails and glue from the installation surface.
- If you suspect that your installation surface might not be suitable, use a straightedge to identify high and low points.
- TIER™ floorboards are suitable for Grade 1 (SANS 10155) floors; permissible deviations should not exceed **3 mm** at any point in a **3 m** line. Small imperfections in some surfaces can be corrected with a belt sander, large imperfections can be corrected with a standard or self-leveling screed. The installation surface should provide a barrier to exterior moisture and be fully cured before installing TIER™ flooring (for allowable limits, refer to Annexure B in SANS 10070).
- Clean and dry the installation surface before installation.
- TIER™ flooring is dimensionally stable at room temperatures, it is therefore not necessary to acclimatise TIER™ flooring before installation.
- TIER™ flooring does not require an underlay, however the installation surface must provide a suitable condition base for the planned use of the room.
- Spacers should be placed around the perimeter of the flooring area to allow for expansion and contraction due to temperature changes. At least a **5 mm** gap is provided for.
- Expansion gaps should also be allowed for whenever the floorboards meet an obstruction. This can include items such as pipes, columns, fireplaces, doorjamb, and even unusually heavy loads. Doorjamb can be undercut to provide a seamless finish between the frame and the boards whilst maintaining an expansion gap below the frame.

- Start in an appropriate corner of the room, typically beginning with a line of full-width boards, note that the opposite end of the laying area will be cut to fit the last space.
- Your TIER™ flooring has a tongue and groove fit system, orientate the floorboards so that the grooves face outward from the starting corner or edge.
- Continue down the line of floorboards laying each subsequent floorboard end to end until the opposite edge of the room is reached.
- Pay particular attention to the edges of the first row of boards ensuring that the click system forms a single continuous line.
- When clicking adjacent boards into place, slip the current board into the transverse joint first. Then slide the board up to the longitudinal joint and click into place. The residential click system will simply slide into place.
- The off-cut from the last piece of the line may be used to start the next line of floorboards.
- To cut a TIER™ floorboard, use an indoor flooring guillotine. Alternatively, for small areas, use a utility knife and deeply score the planned cutting edge on the wear surface side ensuring the cut extends through the wear layer and into the CarbideCore. Place the floorboard on a raised edge fully supporting the board along the line of the score mark and sharply press the raised edge of the floorboard to snap the board. Use the utility knife to subsequently slice through the remaining underlay layer.
- Place the cut edge of each board towards the wall so as to allow for the skirting to cover imperfect cuts.
- Ensure the boards sit firmly under the skirting but do not nail or glue the skirting to the floor. The skirting will secure the boards down providing structure to the entire flooring system. The snug fit between the boards and skirting will also prevent the ingress of debris that could work its way under the boards. **Do not** install TIER™ flooring without some form of skirting.
- Use appropriate caution with the utility knife or guillotine. Warning TIER™ flooring can be razor sharp when cut.
- Remove the spacers around the perimeter of the flooring area. Apply the desired skirting or quarter round along the perimeter of the flooring area to conceal the expansion gaps and hold the floor down.
- Retain excess boards in the event of unforeseen accidents, store them laid flat in a cool, dry area.
- When removing or adjusting a TIER™ floorboard, carefully raise both boards either side of the joint simultaneously. Be cautious to not avoid bending the click system edges of the board.
- If you plan to place heavy structures atop of your TIER™ floor, for example, large pot plants or water features, this will prevent the floor from naturally contracting and expanding past these objects. As a result, expansion gaps will need to be cut into the floor around where an unusually heavy load is placed.

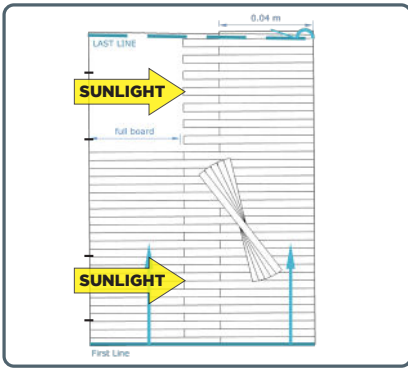

Plan your layout.

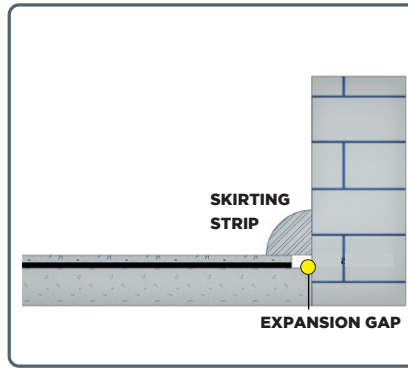

Spacers should be placed around the perimeter of the flooring area to allow for expansion and contraction due to temperature changes. At least a **5 mm gap** is provided for.

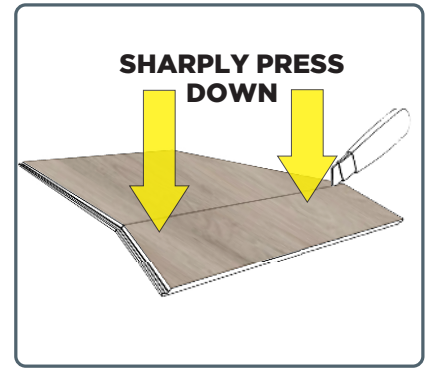

To cut a TIER™ floorboard, use an indoor flooring guillotine. Alternatively for small areas, use a utility knife and deeply score the planned cutting edge on the wear surface side ensuring the cut extends through the wear layer and into the CarbideCore.

## MAINTENANCE

- Sweep or vacuum loose debris regularly.
- Polishes and waxes have no effect on the surface of TIER™ flooring, therefore they are **not recommended**.
- For stubborn dirt, mop your TIER™ floor using a low concentration mixture of water and dish washing liquid. Remove excess water.
- TIER™ flooring is highly water resistant but if a spill occurs, soak up the liquid promptly.
- High traffic areas may wear more quickly, keeping these areas free of dirt and debris is recommended.
- TIER™ flooring is extremely scratch resistant but for peace of mind use felt pads beneath furniture.
- If you plan to move heavy furniture, lift the furniture when moving it.
- TIER™ flooring is suitable for robotic vacuum cleaners and robotic mops.